

DADAS LAS VISTAS DIÉDRICAS DE LAS FIGURAS ABAJO INDICADAS, REPRESENTAR, SIN SUJECIÓN A ESCALA DENTRO DE LOS PRISMAS REPRESENTADOS LA PERSPECTIVA ISOMÉTRICA CORRESPONDIENTE.

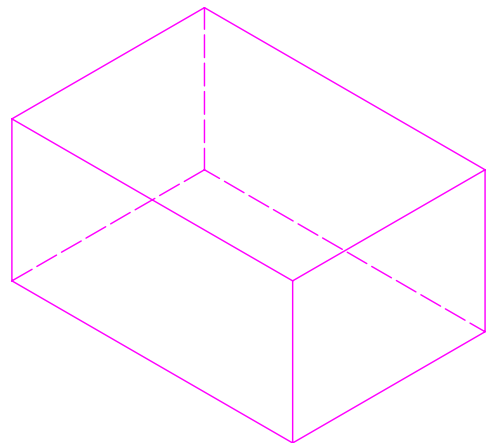
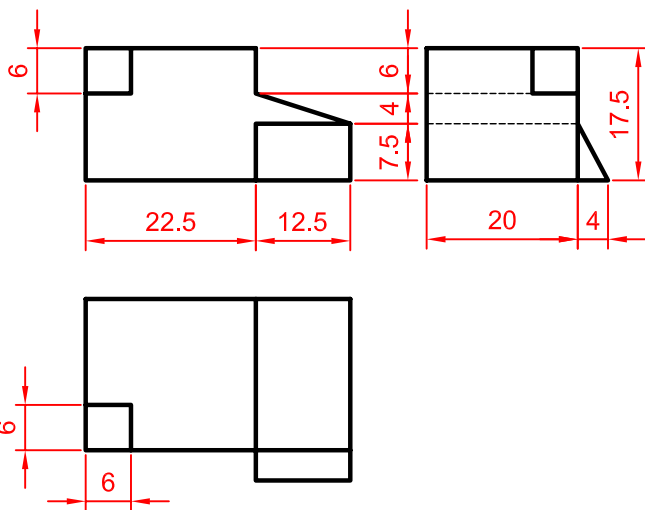
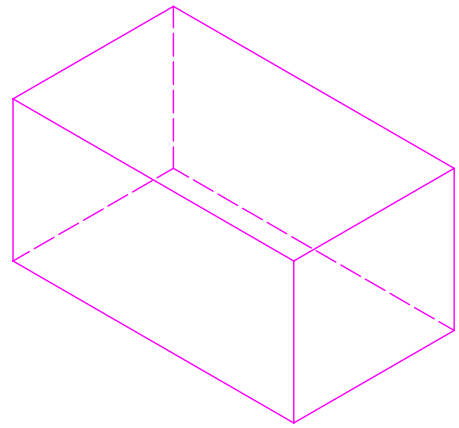
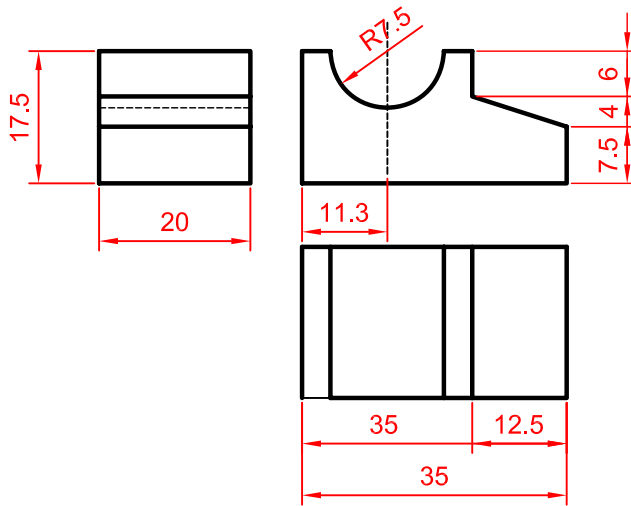
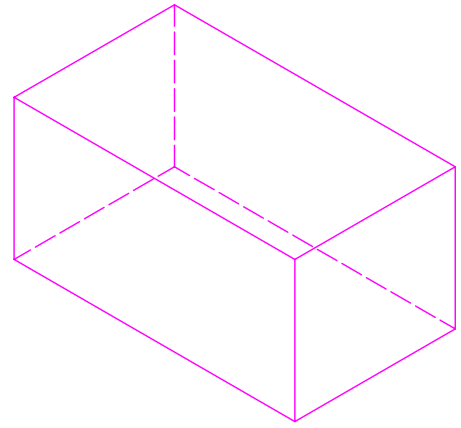
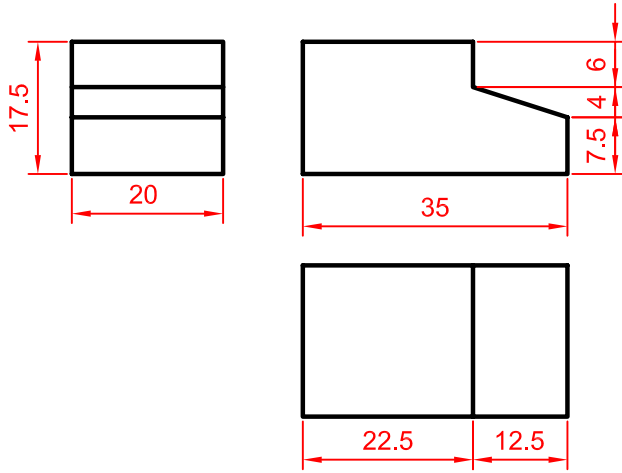

© 2008 www.ramondelaguita.com

NOTA	DIBUJADO	FECHA	NOMBRE APELLIDOS
PRIMERO DE BACHILLERATO LÁMINA 15			